

NOTICE!!

These documents have been scanned!

Do not place un-scanned documents beneath this notice!

Do not remove this notice from this file!

GPO Jacket No. 560-102
Print Order 61540
Rise Business Services, LLC
Job=AZ15 4/26/2019



Box Number= AZ15001



Claim Begin-End: AMC451341-AMC451341

1 Initial Receipt



AZ15001-28

AMC450400-AMC453366

United States Department of the Interior
Bureau of Land Management
 DIV OF LANDS, MINRLS & ENERGY
 ONE N CENTRAL AVE
 PHOENIX, AZ 85004 -4427
 Phone: 602-417-9200

Receipt

No: 4194520

Transaction #: 4309288
Date of Transaction: 06/21/2018
CUSTOMER:
JACOB MIYAUCHI 3408 SOUTHERN VISTA DR KINGMAN, AZ 86401-0629 US

ENTERED
 JUN 28 2018
 BY: RAM

LINE #	QTY	DESCRIPTION	REMARKS	UNIT PRICE	TOTAL
1	1.00	LOCATABLE MINERALS / MINING CLAIMS-NEW, UNADJUD, ONE OR MORE AUTH NOS / NEW MINING CLAIM PROCESSING FEE CASES: AMC451341/\$20.00		- n/a -	20.00
2	1.00	LOCATABLE MINERALS / MINING CLAIMS-NEW, UNADJUD, ONE OR MORE AUTH NOS / NEW MINING CLAIMS LOCATION FEE CASES: AMC451341/\$37.00		- n/a -	37.00
3	1.00	LOCATABLE MINERALS / MINING CLAIMS-NEW, UNADJUD, ONE OR MORE AUTH NOS / NEW MINING CLAIMS MAINTENANCE FEE CASES: AMC451341/\$155.00		- n/a -	155.00
4	2.00	LOCATABLE MINERALS / MINING CLAIMS-NOT NEW-UNADJUD, ONE AUTH NO. ONLY / MINING CLAIM MONEY RECEIVED CASES: AMC451341/\$0.00, AMC451341/\$155.00	ASSOC PLACER 40 Ac.	- n/a -	155.00
TOTAL:					\$367.00

PAYMENT INFORMATION			
NOTE: Items will appear on credit card statement as "Bureau of Land Mgmt CO".			
1	AMOUNT:	367.00	POSTMARKED: N/A
	TYPE:	CREDIT CARD	RECEIVED: 06/21/2018
	NAME:	MIYAUCHI, JACOB 3408 SOUTHERN VISTA DR KINGMAN AZ 86401-0629 US	
	CARD NO:	XXXXXXXXXXXX2420	AUTH CODE: 06840D
	NAME ON		

CARD:	TERENCE S MIYAUCHI
SIGNATURE:	

REMARKS

This receipt was generated by the automated BLM Collections and Billing System and is a paper representation of a portion of the official electronic record contained therein.

NOTICE!!

These documents have been scanned!

Do not place un-scanned documents beneath this notice!

Do not remove this notice from this file!

GPO Jacket No. 560-102
Print Order 61540
Rise Business Services, LLC
Job=AZ15 4/26/2019



Box Number= AZ15001



Claim Begin-End: AMC451341-AMC451341

2 Correspondence



AZ15001-28

AMC450400-AMC453366

**NO
DOCUMENTS
FOUND**

NO DOCUMENTS FOUND
NO DOCUMENTS FOUND

NOTICE!!

These documents have been scanned!

Do not place un-scanned documents beneath this notice!

Do not remove this notice from this file!

GPO Jacket No. 560-102
Print Order 61540
Rise Business Services, LLC
Job=AZ15 4/26/2019



Box Number= AZ15001



Claim Begin-End: AMC451341-AMC451341

3 Transfers



AZ15001-28

AMC450400-AMC453366

**NO
DOCUMENTS
FOUND**

NO DOCUMENTS FOUND
NO DOCUMENTS FOUND

NOTICE!!

These documents have been scanned!

Do not place un-scanned documents beneath this notice!

Do not remove this notice from this file!

GPO Jacket No. 560-102
Print Order 61540
Rise Business Services, LLC
Job=AZ15 4/26/2019



Box Number= AZ15001



Claim Begin-End: AMC451341-AMC451341

4 Annual Filings



AZ15001-28

AMC450400-AMC453366

FEE# 2018058115

OFFICIAL RECORDS
OF MOHAVE COUNTY
KRISTI BLAIR,
COUNTY RECORDER



448767
451341
426089

11/23/2018 04:12 PM Fee: \$10.00

PAGE: 1 of 2

NOTICE OF INTENTION TO HOLD MINING CLAIMS/SITES

When Recorded Return Document to:

JACOB MIYAUCHI
925 N. COLLEGE AVE #F222
TEMPE, AZ 85281

RECEIVED
BLM AZ STATE OFFICE
2018 NOV 26 P 12:33
PHOENIX, ARIZONA
BLM
Date
Stamp

Check here if this is a change of address.

Telephone: 928-303-0554

E-mail Address: mountainstatesmining@gmail.com

I (We) intend to hold the claims(s) and/or site(s) listed below for the calendar year 2019, and I (We) have filed or will file a Notice of Intent to Hold in the county where the claim (s) is located.

Reason for filing a Notice of Intent to Hold instead of an assessment work filing (check one):

- Maintenance fee was paid to maintain claim(s) during this assessment year.
- Mill or tunnel sites.
- Claim(s) was located during the current assessment year.
- BLM has deferred assessment work (attach copy of decision granting deferment, or pending petition for deferment including date petition was filed.)

Line No.	AMC NUMBER	CLAIM/SITE NAME	COUNTY RECORDER DATA (If available)	TWP	RNG	SEC
1	448767	MSM #01		29N	17W	22
2						
3						
4						
5						
6						
7						
8						
9						
10						

ENTERED
NOV 30 2018
BY: RAM

ilmazsoIAC



ilmazsoIAC

xdo.pdf

11/26/18 11:02 AM

NOTICE OF INTENTION TO HOLD MINING CLAIMS/SITES
page 2

RECEIVED
BLM AZ STATE OFFICE
2018 NOV 26 P 12:33
PHOENIX, ARIZONA

BLM
Date
Stamp

1. State of Arizona, County of MOHAVE

2. I (Name) JACOB MIYAUCHI

3. Reside at (Address) 925 N. COLLEGE AVE #F222

City TEMPE County MARICOPA State AZ Zip 85281 being duly sworn, depose and say that I am a citizen of the United States, more than eighteen years of age, that all of the facts set forth in this notice, subject to the provisions and penalties of 18 U.S.C. 1001 pertaining to the filing of false, fictitious, or fraudulent statements with the United States, are true and correct according to the best of my knowledge, information and belief.

4. Owner's name and address (If not shown in Items 1-3 above). _____

5. Dated: 11/21/18 Signature: Jacob Miyauchi

Bureau of Land Management
Arizona State Office
www.blm.gov/az

No. of Claims: 1 x \$10 = 15
Check No: _____ Init. PER
Receipt No.: 4316306
For BLM Use Only

1202162-2-2-2
 castilloe

NOTICE OF INTENTION TO HOLD MINING CLAIMS/SITES

When Recorded Return Document to:

JACOB MIYAUCHI
925 N. COLLEGE AVE # F222
TEMPE, AZ 85281

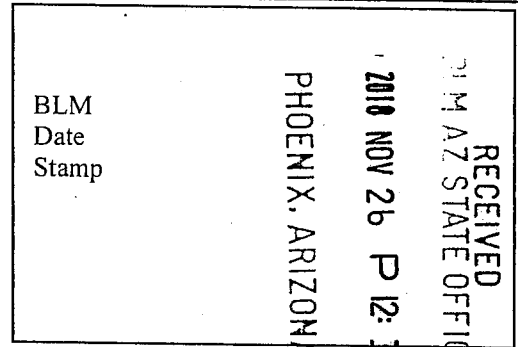

Check here if this is a change of address.

Telephone: 928-303-0554

E-mail Address: mountainstatesmining@gmail.com

I (We) intend to hold the claims(s) and/or site(s) listed below for the calendar year 20___, and I (We) have filed or will file a Notice of Intent to Hold in the county where the claim (s) is located.

Reason for filing a Notice of Intent to Hold instead of an assessment work filing (check one):

- Maintenance fee was paid to maintain claim(s) during this assessment year.
- Mill or tunnel sites.
- Claim(s) was located during the current assessment year.
- BLM has deferred assessment work (attach copy of decision granting deferment, or pending petition for deferment including date petition was filed.)

Line No.	AMC NUMBER	CLAIM/SITE NAME	COUNTY RECORDER DATA (If available)	TWP	RNG	SEC
1	451341	MSM #02		50N	60W	12
2						
3						
4						
5						
6						
7						
8						
9						
10						

NOTICE OF INTENTION TO HOLD MINING CLAIMS/SITES
page 2

RECEIVED
BLM AZ STATE OFFICE
2018 NOV 26 P 12:33
PHOENIX, ARIZONA
BLM
Date
Stamp

1. State of Arizona, County of MARICOPA

2. I (Name) JACOB MIYAUCHI

3. Reside at (Address) 925 N. COLLEGE AVE #F222

City TEMPE County MARICOPA State AZ zip 85281 being duly sworn, depose and say that I am a citizen of the United States, more than eighteen years of age, that all of the facts set forth in this notice, subject to the provisions and penalties of 18 U.S.C. 1001 pertaining to the filing of false, fictitious, or fraudulent statements with the United States, are true and correct according to the best of my knowledge, information and belief.

4. Owner's name and address (If not shown in Items 1-3 above): _____

5. Dated: 11/21/18 Signature: Jacob Miyauchi

Bureau of Land Management
Arizona State Office
www.blm.gov/az

No. of Claims: 1 x \$¹⁵10 = _____
Check No: _____ Init. PER
Receipt No.: 4316306
For BLM Use Only

JACOB MIYACHI
925 N. COLLEGE AVE. # F222
TEMPE, AZ 85281

OFFICIAL RECORDS OF
MARICOPA COUNTY RECORDER
ADRIAN FONTES
2018-0868942 11/26/18 12:24
PAPER RECORDING

Check here is this is a change of address.

Telephone: 928-303-0554

E-mail address: mountainstatesmining@gmail.com

1202162-2-2-1
castilloe

AFFIDAVIT OF PERFORMANCE OF ANNUAL WORK

1. State of Arizona, County of MARICOPA ss:

2. I (Name) JACOB MIYACHI

3. Reside at (Address) 925 N. COLLEGE AVE # F222

City TEMPE County MARICOPA

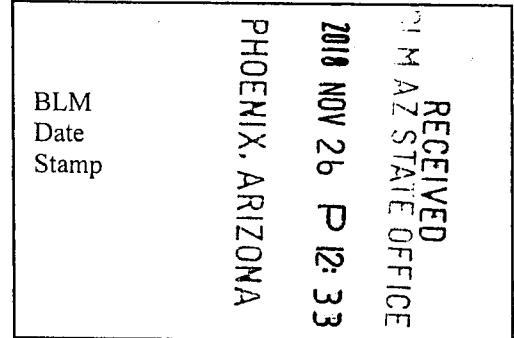

State AZ Zip 85281 being duly sworn, depose and say that I am a citizen of the United States, more than eighteen years of age, and that all of the facts set forth in this affidavit, subject to the provisions and penalties of 18 U.S.C. 1001 pertaining to the filing of false, fictitious, or fraudulent statements with the United States, are true and correct according to the best of my knowledge, information and belief.

4. Owner's name and address (If not shown in Items 1-3 above).

5. That I am personally acquainted with the mining claim(s). The work and improvements were made by and at the expense of the owner(s) of said claim(s). Said contiguous group of claims, listed on this document, are situated in the

(optional) Mining District; County, Arizona.

Line No.	AMC NUMBER	CLAIM/SITE NAME	COUNTY RECORDER DATA (If available)	TWP	RNG	SEC
1	451341	MSM #02		50N	60W	12
2						
3						
4						
5						
6						

RECEIVED
BLM AZ STATE OFFICE
PHOENIX, ARIZONA
2018 NOV 26 P 12:33

BLM
Date
Stamp

7					
8					
9					
10					

6. That between the dates starting at 12 o'clock noon on September 1, 20 17 and ending at 12 o'clock noon on September 1, 20 at least \$ 300.00 dollars worth of work and improvements were done and performed upon said claim(s) or upon one or more of a contiguous group of claims for the benefit of all, wholly or partly outside of a contiguous group of claims for the benefit of all, not including the location work.

7. That the following persons were employed to perform the work and improvements described herein: JACOB MIYAUCHI, TERRY MIYAUCHI

8. That the work and improvements performed were: ROAD IMPROVEMENTS

9. Dated: 11/26/18 Signature: Jacob Miyouchi

SUBSCRIBED AND SWORN TO before me, a Notary Public, this 26 day of November 20 18

By: Jacob Miyouchi

Notary Public [Signature]

My Commission Expires 12/14/20

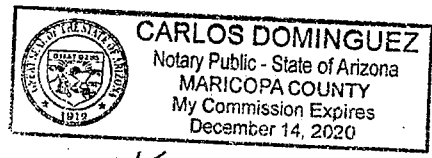

Bureau of Land Management
Arizona State Office
www.blm.gov/az

No. of Claims: 1 x \$¹⁵10 =
 Check No.: Init. PER
 Receipt No.: 4316306
 For BLM Use Only

JACOB MIYAUCHI
925 N. COLLEGE AVE #F222
TEMPE, AZ 85281

FEE# 2018058116

OFFICIAL RECORDS
OF MOHAVE COUNTY
KRISTI BLAIR,
COUNTY RECORDER



11/23/2018 04:12 PM Fee: \$15.00

PAGE: 1 of 2

Check here is this is a change of address.

Telephone: 928-303-0554

E-mail address: mountainstatesmining@gmail.com

AFFIDAVIT OF PERFORMANCE OF ANNUAL WORK

1. State of Arizona, County of MOHAVE ss:

2. I (Name) JACOB MIYAUCHI

3. Reside at (Address) 925 N. COLLEGE AVE #F222

MM

City TEMPE County MARICOPA

State AZ Zip 85281 being duly sworn, depose and say that I am a citizen of the United States, more than eighteen years of age, and that all of the facts set forth in this affidavit, subject to the provisions and penalties of 18 U.S.C. 1001 pertaining to the filing of false, fictitious, or fraudulent statements with the United States, are true and correct according to the best of my knowledge, information and belief.

4. Owner's name and address (If not shown in Items 1-3 above).

RECEIVED
BLM AZ STATE OFFICE
2018 NOV 26 P 12:33
PHOENIX, ARIZONA

BLM
Date
Stamp

5. That I am personally acquainted with the mining claim(s). The work and improvements were made by and at the expense of the owner(s) of said claim(s). Said contiguous group of claims, listed on this document, are situated in the

(optional) Mining District; MOHAVE County, Arizona.

Line No.	AMC NUMBER	CLAIM/SITE NAME	COUNTY RECORDER DATA (If available)	TWP	RNG	SEC
1	426089	AU DIGGER		29N	17W	22
2	448767	MSM #01		29N	17W	22
3						
4						
5						
6						

RECEIVED
BLM AZ STATE OFFICE
2018 NOV 26 P 12:33
PHOENIX, ARIZONA

BLM
Date
Stamp

7						
8						
9						
10						

6. That between the dates starting at 12 o'clock noon on September 1, 20 17 and ending at 12 o'clock noon on September 1, 20 18 at least \$ 900.00 dollars worth of work and improvements were done and performed upon said claim(s) or upon one or more of a contiguous group of claims for the benefit of all, wholly or partly outside of a contiguous group of claims for the benefit of all, not including the location work.

7. That the following persons were employed to perform the work and improvements described herein: JACOB MIYAUCHI, TERRY MIYAUCHI

8. That the work and improvements performed were: BULK SAMPLING & ROAD IMPROVEMENTS

9. Dated: 11/23/18 Signature: Jacob Miyouchi

SUBSCRIBED AND SWORN TO before me, a Notary Public, this 23rd day of November 20 18

By: Jacob Miyouchi
Notary Public Kelly Nockideneh
My Commission Expires 03-29-2019

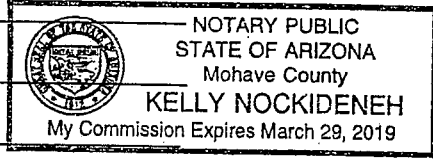

Bureau of Land Management
Arizona State Office
www.blm.gov/az

No. of Claims: 2 x \$ 15 = 30
Check No.: _____ Init. PER
Receipt No.: 4316306
For BLM Use Only

United States Department of the Interior
Bureau of Land Management
 DIV OF LANDS, MINRLS & ENERGY
 ONE N CENTRAL AVE
 PHOENIX, AZ 85004 -4427
 Phone: 602-417-9200

Receipt	
No:	4316306

Transaction #: 4432748
Date of Transaction: 11/26/2018

CUSTOMER:

JACOB MIYAUCHI
 3408 SOUTHERN VISTA DR
 KINGMAN, AZ 86401-0629 US

LINE #	QTY	DESCRIPTION	REMARKS	UNIT PRICE	TOTAL
1	1.00	LOCATABLE MINERALS / MINING CLAIMS- NOT NEW-UNADJUD, ONE AUTH NO. ONLY / MINING CLAIM MONEY RECEIVED CASES: AMC448767/\$75.00	NOI/2 AND POL/3	- n/a -	75.00
TOTAL:					\$75.00

PAYMENT INFORMATION

NOTE: Items will appear on credit card statement as "Bureau of Land Mgmt CO".

1	AMOUNT:	75.00	POSTMARKED:	N/A
	TYPE:	CREDIT CARD	RECEIVED:	11/26/2018
	NAME:	MIYAUCHI, JACOB 3408 SOUTHERN VISTA DR KINGMAN AZ 86401-0629 US		
	CARD NO:	XXXXXXXXXXXX8876	AUTH CODE:	H42095
	NAME ON CARD:	JACOB S MIYAUCHI		
	SIGNATURE:			

REMARKS

This receipt was generated by the automated BLM Collections and Billing System and is a paper representation of a portion of the official electronic record contained therein.

496

AMC 426089 448767

MAINTENANCE FEE WAIVER CERTIFICATION

FORM APPROVED OMB NO. 1004-0114 Expires:

45134

SEE INSTRUCTIONS ON PAGE 2

- 1. This small miner waiver is filed for the assessment year beginning on September 1, 2018 and ending on September 1, 2019.
2. The undersigned and all related parties owned ten or fewer mining claims, mill, or tunnel sites located and maintained on Federal lands in the United States of America on September 1, 2018.
3. The undersigned have performed the assessment work required by law for each mining claim listed prior to filing this waiver and understand that by filing this form, the undersigned must file an affidavit of assessment work with the Bureau of Land Management (BLM) by the December 30th following the filing of this waiver.
4. The undersigned understand that if the assessment work obligation has not yet come due under 30 U.S.C. 28 (for those claims in their first assessment year only), a notice of intent to hold reciting this condition must be recorded by the December 30th following the filing of this waiver.
5. The undersigned understand that mill and tunnel sites may also be listed on this waiver and be waived from payment of the maintenance fee, and that a notice of intent to hold for these sites is required to be filed with the BLM by the December 30th following the filing of this waiver.
6. The undersigned understand and acknowledge that pursuant to 43 U.S.C. 1212 and 18 U.S.C. 1001, the filing or recording of a false, fictitious, or fraudulent document with the BLM may result in a fine of up to \$250,000, a prison term not to exceed five years, or both.
7. The mining claims, mill or tunnel sites for which this waiver from payment of the maintenance fees is requested are:

Table with 2 columns: CLAIM OR SITE NAME, BLM RECORDATION SERIAL NUMBER. Rows include Au Digger #1, MSM #01, MSM #02, and a vertical stamp: PHOENIX, ARIZONA 2018 AUG 29 P 2:51 BLM AZ STATE OFFICE RECEIVED

The owner(s) (claimants) of the above mining claims and sites are:

Jacob Miyauchi

(Owner's Name - Please Print)

3408 Southern Vista Drive

(Owner's Mailing Address)

Jacob Miyauchi (Owner's Signature)

Kingman

(City)

AZ

(State)

86401

(Zip Code)

Terence Miyauchi

(Owner's Name - Please Print)

3408 Southern Vista Drive

(Owner's Mailing Address)

Terence Miyauchi (Owner's Signature)

Kingman

(City)

AZ

(State)

86401

(Zip Code)

Kimberly Miyauchi

(Owner's Name - Please Print)

3408 Southern Vista Drive

(Owner's Mailing Address)

Kimberly Miyauchi (Owner's Signature)

Kingman

(City)

AZ

(State)

86401

(Zip Code)

Greg Miyauchi

(Owner's Name - Please Print)

PO Box 282

(Owner's Mailing Address)

Greg Miyauchi (Owner's Signature)

Grand Lake

(City)

CO

(State)

80447

(Zip Code)

2478483 ENTERED SEP 10 2018

(Continued on page 2)

BY:

nwl

Joan Miyauchi

(Owner's Name - Please Print)

Joan Miyauchi

(Owner's Signature)

PO Box 282

(Owner's Mailing Address)

Grand Lake

(City)

CO

(State)

80447

(Zip Code)

Tammy Roussopoulos

(Owner's Name - Please Print)

Tammy Roussopoulos

(Owner's Signature)

2285 N Warwick Ave

(Owner's Mailing Address)

Meridian

(City)

ID

(State)

83646

(Zip Code)

(Owner's Name - Please Print)

(Owner's Signature)

(Owner's Mailing Address)

(City)

(State)

(Zip Code)

(Owner's Name - Please Print)

(Owner's Signature)

(Owner's Mailing Address)

(City)

(State)

(Zip Code)

18 U.S.C. 1001 and 43 U.S.C. 1212 make it a crime for any person knowingly and willfully to make to any department or agency of the United States any false, fictitious or fraudulent statements or representations as to any matter within its jurisdiction.

INSTRUCTIONS

1. This certification is made under the provisions of 43 U.S.C. § 1744 and 30 U.S.C. §28-28k and the regulations thereunder (43 CFR Part 3830).
2. The claimant(s) must fill in the dates in paragraph 1 for the beginning and ending of the assessment year for which this waiver is sought.
3. The claimant(s) must fill in the date in paragraph 2 for the beginning of the assessment year for which this waiver is sought.
4. All claim and site names and BLM serial numbers must be listed for the mining claims, mill sites, and tunnel sites for which the waiver is sought.
5. All owners of the mining claims, mill sites, and tunnel sites and their addresses must be given.
6. This waiver form must be signed by all the claimants or their designated agent, in original form. If an agent is designated, a notarized designation of agent, signed by all of the claimants with proper address given, must be submitted with this waiver.
7. This form must be filed no later than September 1st for the upcoming assessment year in the BLM State Office where the mining claims or sites are recorded, or the waiver cannot be granted by the BLM. (Example: To obtain a waiver for the assessment year 2012, which begins on September 1, 2011, you must qualify for and file for a waiver no later than September 1, 2011, in the proper BLM State Office.)
8. For all mining claims which require assessment work, you must record an affidavit of labor on or before the December 30th immediately following the filing of this waiver. For all other mining claims or sites waived, you must record a notice of intent to hold on or before the December 30th immediately following the filing of this waiver.
9. Mill and tunnel sites may also be listed on this waiver and be waived from payment of the maintenance fee. A notice of intent to hold for these sites is required to be filed by the December 30th following the filing of this waiver.

PHOENIX, ARIZONA
 2011 AUG 29 P 2:51
 RECEIVED
 BLM STATE OFFICE
 FOR OFFICIAL USE ONLY

JACOB MIYAUCHI
3408 SOUTHERN VISTA DRIVE
KINGMAN, AZ 86401

CERTIFIED MAIL®



7016 0910 0001 7619 2156

BUREAU OF LAND MANAGEMENT
1 N CENTRAL AVE SUITE 800
PHOENIX, AZ 85004

\$3.920
US POS
FIRST-CL
071S0091
85281

PHOENIX, ARIZONA

2010 AUG 29 P 2:51

POSTAL STATE OFFICE

8500484497 0041

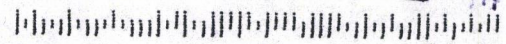

DEPARTMENT OF THE INTERIOR
BUREAU OF LAND MANAGEMENT
MINING CLAIMS

Run Date/Time: 9/11/2018

MC Maintenance Fees Paid Through the BLM Pay Portal
(by Date Paid)

Page 6 Of 723

CBS Receipt: 4238713

Printed For Lead File # AMC451342

Agency Tracking ID: 1534708186

Assessment Year: 2019

Number of BLM Serial Nr: 22

Paid On: 8/19/2018

Total Amount Paid: \$3,410.00

Claim Name	BLM Serial No	Lead File No	Amount Paid
EN 120	AMC451363	AMC451342	\$155.00
EN 121	AMC451364	AMC451342	\$155.00
EN 127	AMC451365	AMC451342	\$155.00
EN 128	AMC451366	AMC451342	\$155.00
EN 129	AMC451367	AMC451342	\$155.00
EN 135	AMC451368	AMC451342	\$155.00
EN 136	AMC451369	AMC451342	\$155.00
EN 137	AMC451370	AMC451342	\$155.00
EN 138	AMC451371	AMC451342	\$155.00
EN 140	AMC451372	AMC451342	\$155.00
EN 142	AMC451373	AMC451342	\$155.00
EN 144	AMC451374	AMC451342	\$155.00
EN 146	AMC451375	AMC451342	\$155.00
EN 148	AMC451376	AMC451342	\$155.00
EN 150	AMC451377	AMC451342	\$155.00
EN 151	AMC451378	AMC451342	\$155.00
EN 152	AMC451379	AMC451342	\$155.00
EN 153	AMC451380	AMC451342	\$155.00
EN 154	AMC451381	AMC451342	\$155.00
EN 155	AMC451382	AMC451342	\$155.00
EN 156	AMC451383	AMC451342	\$155.00
EN 157	AMC451384	AMC451342	\$155.00

**United States Department of the Interior
Bureau of Land Management
BUSINESS & SUPPORT SVCS DIV
ONE N CENTRAL AVE SUITE 800
PHOENIX, AZ 85004 -4427
Phone: 602-417-9200**

Receipt

No: 4238713

Transaction #: 4354108	
Date of Transaction: 08/19/2018	
CUSTOMER:	
JOEL ADAMS 145 WEST 67TH NEW YORK, NY 10023 US	

LINE #	QTY	DESCRIPTION	REMARKS	UNIT PRICE	TOTAL
1	1.00	LOCATABLE MINERALS / MINING CLAIMS- NOT NEW-UNADJUD, ONE AUTH NO. ONLY / MINING CLAIM MONEY RECEIVED CASES: AMC451363/\$3410.00		- n/a -	3410.00
TOTAL:					\$3,410.00

PAYMENT INFORMATION				
NOTE: Items will appear on credit card statement as "BLM O Mining Claim".				
1	AMOUNT:	3410.00	POSTMARKED:	N/A
	TYPE:	CREDIT CARD	RECEIVED:	08/19/2018
	NAME:	JOEL ADAMS 145 WEST 67TH NEW YORK NY 10023 US		
	CARD NO:	XXXXXXXXXXXX2270	AUTH CODE:	048246
	NAME ON CARD:	JOEL ADAMS		
	SIGNATURE:			

REMARKS

This receipt was generated by the automated BLM Collections and Billing System and is a paper representation of a portion of the official electronic record contained therein.

NOTICE!!

These documents have been scanned!

Do not place un-scanned documents beneath this notice!

Do not remove this notice from this file!

GPO Jacket No. 560-102
Print Order 61540
Rise Business Services, LLC
Job=AZ15 4/26/2019



Box Number= AZ15001



Claim Begin-End: AMC451341-AMC451341

5 Miscellaneous



AZ15001-28

AMC450400-AMC453366

**NO
DOCUMENTS
FOUND**

NO DOCUMENTS FOUND
NO DOCUMENTS FOUND

NOTICE!!

These documents have been scanned!

Do not place un-scanned documents beneath this notice!

Do not remove this notice from this file!

GPO Jacket No. 560-102
Print Order 61540
Rise Business Services, LLC
Job=AZ15 4/26/2019



Box Number= AZ15001



Claim Begin-End: AMC451341-AMC451341

6 Location Notices-Amendments and Supporting Documents



AZ15001-28

AMC450400-AMC453366

MINING CLAIM STATUS REPORT

Data Entered: 6/28/18 RUM

MTP Checked By: EC

GEO Checked By: EC

LEAD SERIAL NUMBER: AMC 451341 thru AMC _____

NUMBER OF CLAIMS & TYPE:

_____ LODGE
 _____ PLACER
1 ASSOCIATION PLACER
 _____ MILL SITE
 _____ TUNNEL SITE

CHARGES:

Processing Fee @ \$20 = \$ 20
 Location Fee @ \$37 = \$ 37
 Maintenance Fee @ \$155 = \$ 155
 Add'l Maint Fee for Assoc Placer = \$ 155
SUBTOTAL \$ 367
 _____ Other Fees \$ _____
 _____ Other Fees \$ _____
TOTAL \$ _____

TOTAL ACREAGE: 40. Per Claim
(Placer Only)

NUMBER OF LOCATORS: 2

DOCUMENTS RECEIVED VIA: Over-the-Counter Mail TIMELY FILED: Yes No

LEGAL DESCRIPTION: T 5N R 6W SEC 12
 T _____ R _____ SEC _____
 T _____ R _____ SEC _____
 T _____ R _____ SEC _____
 T _____ R _____ SEC _____

BLM FOREST SERVICE SUBJ TO PL 359: Yes No
WILDERNESS AREA

SPLIT ESTATE: N/A SX PX OTHER
SRHA Was proper Notice filed if located on SHRA Land? Yes No

RECONVEYED MINERALS ON BLM LAND REQUIRE OPENING ORDER FROM 1944 TO 1993:

Open to Entry On _____ N/A

COMMENTS/STATUS: VOID PARTIALLY VOID PVT MINERALS WITHDRAWN LANDS
OTHER

Claimant acknowledges that portions of the following claim(s) site(s) may be void or voidable.

Printed Name of Claimant _____

Signature of Claimant _____

*****FINAL ADJUDICATION*****

DATE 8/16/18

INITIALS RS

AMC 451341

0635793-3-1-1
castilloe

LOCATION NOTICE FOR PLACER MINING CLAIM

Amendment BLM Serial # _____

NOTICE IS HEREBY GIVEN that the MSM #02
_____ placer mining claim has been located by
Jacob Miyauchi whose current mailing
address is 3408 Southern Vista Drive, Kingman, AZ 86401

RECEIVED
BLM AZ STATE OFFICE
2018 JUN 21 P 1:29
PHOENIX, ARIZONA
BLM
Date
Stamp

The general course of this claim is North - South and it is situated in Maricopa
County, Arizona. This claim is 2640 feet in length and 660 feet in width.

40 Total Claim Acreage. This claim runs from the location monument on which this location notice is
posted at the NE corner of the claim approximately 660 feet in a West direction to the
West end line and 2640 feet in a South direction to the South end line. This claim is
marked by four monuments, one at each corner of the claim.

The location monument on which this notice is posted is situated within Section 12, Township
5 N, Range 6 W, Gila Salt River Base and Meridian, Arizona. This claim encompasses
portions of the following legal subdivision(s) if located by legal subdivision or the following quarter section(s),
section(s), Township(s) and Range(s) West 1/2 of the NW 1/4 and West 1/2 of the SW 1/4,
of the SE 1/4, of Section 12, T 5N, R 6W, Gila Salt River Base and Meridian, Arizona.

The locality of this claim with reference to some natural object or permanent monument and additional information
(if any) concerning its locality are as follows: The western boundary of the claim is aprx. 0.75 miles from
Vulture Mine Road. The northern and southern boundary are symmetric to and 0.5 miles due west
of W Painted Wagon Trail and W Dove Valley Rd. The above information is shown on the attached map.

DATED AND POSTED on the ground this 19 day of June, 2018.

LOCATOR(s) AGENT

Print Name(s) Jacob Miyauchi

Signature(s) Jacob Miyauchi

Form MCF102
Revised July 2014

AMC451341

MINING CLAIM MAP

Lode () Placer ()
Millsite ()

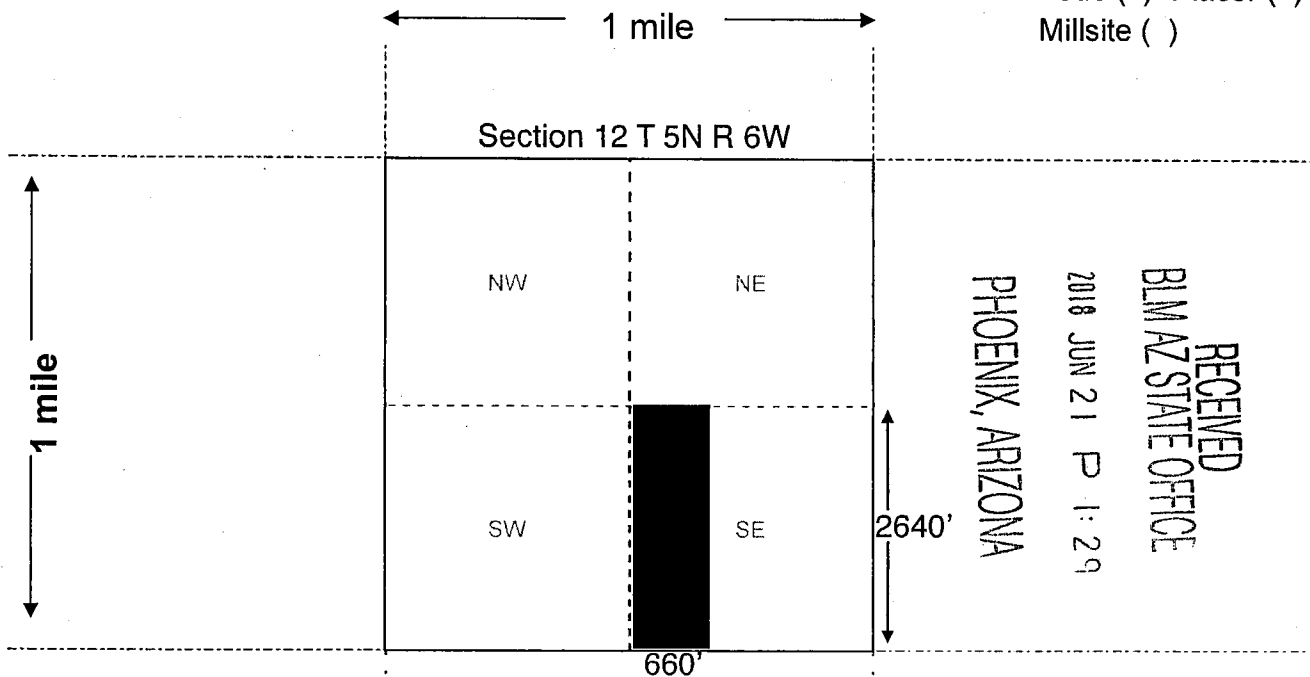

RECEIVED
BLMAZ STATE OFFICE
2018 JUN 21 P 1:29
PHOENIX, ARIZONA

Scale: 1" = 2000 feet



1. The above map depicts the MSM #02 mining claim, which is located in Section (s) 12, Township 5 N, Range 6 W, Gila and Salt River Base and Meridian, Maricopa County, Arizona. Total claim acreage is 40 acres.

2. The type of corner and location monuments used are as follows: 1' x 1' x 5' metal stakes with inscribed metal tags.

3. The bearings and distances in degrees and feet between claim corners and to a public land survey monument are as depicted on the map.

4. If the claim is a placer or millsite claim with exterior limits conforming to legal subdivisions of the public survey, provide a legal description of the claim W 1/2 of NW 1/4 and W1/2 of SW 1/4, of the SE 1/4, of Section 12, T 5N, R 6W

Form MCF100a
Revised July 2014

This form is available from the Arizona Geology Survey and may be reproduced.

AMC451341

Location Notice For Placer Mining Claim: Additional Signatures

Claimant/Locator 1:

Name: SALOB MIYAUCHI

Mailing Address: 3408 SOUTHERN VISTA DR, KINGMAN AZ 86401

Signature:  Date: 6/15/18

Claimant 2:

Name: TERENCE MIYAUCHI

Mailing Address: 3408 SOUTHERN VISTA DR, KINGMAN AZ 86401

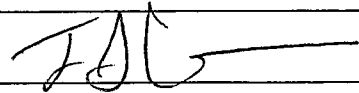
Signature:  Date: 6/19/18

ANC451341

RECEIVED
BLM AZ STATE OFFICE
2018 JUN 21 P 1:29
PHOENIX, ARIZONA

DEPARTMENT OF INTERIOR
BUREAU OF LAND MANAGEMENT

Input Parameters for Geographic Report with Land

System Id = CR

Admin State = AZ

Geo State =

Casetype Begins With

Case Disp Txt = AUTHORIZED, CANCELLED, EXPIRED, PENDING, REJECTED, RELINQUISHED, VOID, WITHDRAWN

Mer Twp Rng = 14 0050N 0060W

Section = 012, 999

Mtrs =

Commodity =

Commodity Txt =

Pending Org =

Pend Org Decode =

Total Rows Returned: 4

RUN TIME: 01:10 PM

Adm State: AZ

UNITED STATES DEPARTMENT OF INTERIOR
BUREAU OF LAND MANAGEMENT
GEOGRAPHIC REPORT WITH LAND
Sorted by Serial Number

RUN DATE: 06/21/2018
Page 1 of 1

Serial Number: AZA 027761
Total Case Acres: 13.880

<u>Casetype</u>	<u>Case Disp</u>	14	0050N	0060W	<u>Sect</u>	<u>Sur Typ</u>	<u>Sur Num</u>	<u>Suff</u>	<u>Subdivision</u>	<u>Act Pend</u>
281001	AUTHORIZED				012	ALIQ			N2N2;	

Serial Number: AZA 030979
Total Case Acres: 4.020

<u>Casetype</u>	<u>Case Disp</u>	14	0050N	0060W	<u>Sect</u>	<u>Sur Typ</u>	<u>Sur Num</u>	<u>Suff</u>	<u>Subdivision</u>	<u>Act Pend</u>
281001	AUTHORIZED				012	ALIQ			NWNW;	

Serial Number: AZA 033383
Total Case Acres: 26.300

<u>Casetype</u>	<u>Case Disp</u>	14	0050N	0060W	<u>Sect</u>	<u>Sur Typ</u>	<u>Sur Num</u>	<u>Suff</u>	<u>Subdivision</u>	<u>Act Pend</u>
286203	AUTHORIZED				012	ALIQ			E2NE,NWNW;	

Serial Number: AZA 03338301
Total Case Acres: 39.450

<u>Casetype</u>	<u>Case Disp</u>	14	0050N	0060W	<u>Sect</u>	<u>Sur Typ</u>	<u>Sur Num</u>	<u>Suff</u>	<u>Subdivision</u>	<u>Act Pend</u>
280004	AUTHORIZED				012	ALIQ			E2NE,NWNW;	

TOWNSHIP 05 NORTH RANGE 06 WEST OF THE GILA & SALT RIVER MERIDIAN, ARIZONA

SECS	SUBDIVISION																Acres	Kind of Entry or Purpose	Serial Number or Order Number	Action Date	Remarks				
	NE 1/4				NW 1/4				SW 1/4				SE 1/4									Lots	Other Description		
	NE	NW	SW	SE	NE	NW	SW	SE	NE	NW	SW	SE	NE	NW	SW	SE									
	For orders affecting disposal or use of unidentified lands withdrawn for classification, minerals, water, and/or other public purposes, and Indian treaties, refer to Index to Miscellaneous Documents																								
																	M&B;	PATENT / VULTURE CITY TOWNSITE	171	6/20/1882	6N 6W;				
																	ALL SECS 2, 16, 32, 36;	STATE GRANT	ACT OF CONGRESS	6/20/1910	TITLE TO STATE TO FIX ON APPROVAL OF SURVEY; SUBJECT TO PRIOR RIGHTS;				
8	X	X	X	X												X	X	X	X	320.00					
9																				640.00	ALL;				
10																				640.00	ALL; 5N 5W;	PERMIT / OG	PHX-054260	1/11/1923	CANC 8/23/1928;
1																					ALL;				
3																					ALL;				
11																					ALL;				
12																				2559.88	ALL;	PERMIT / OG	PHX-054124	3/3/1923	CANC 4/19/1928;
																					ALL SECS 2, 16, 32, 36;	STATE GRANT	ACT OF CONGRESS	1/25/1927	EXTENDS ACT OF 6/20/1910 TO MINERAL LANDS; SUBJECT TO PRIOR RIGHTS;
30																				638.92	ALL;				
31																				639.48	ALL;	PATENT / SX	1113346	3/7/1942	OTHER TPS: 9N 1W, 9N 3W, 11N 6W, 13N 9W, 14N 9W;
28																				640.00	ALL;				
29																				640.00	ALL;				
33																				640.00	ALL;	PATENT / SX	1113361	3/9/1942	21N 12W;
19																									
29																									
30																									
32																									
33																					M&B; SUBDIV UNDEF;	R/W TRANSMISSION LINE	PHX-080582	7/20/1942	PERPETUAL; 11N 8W; PD ONLY; PART REL 4/7/1988;
19																									
20																									
30																									
32																									
33																					M&B; SUBDIV UNDEF;	R/W TRANSMISSION LINE	PHX-082297	2/2/1950	PERPETUAL; 11N 18W; PD ONLY;
2			X	X			X	X	X	X	X	X	X	X	X	X	X	X	X	1, 2		QCD TO US / SX	PHX-081304	3/25/1950	NOT OPEN TO THE LAND LAWS OR MINERAL LAWS;
35																					W2NWNWNW;	SLUP	AR-06015	4/13/1954	TO TERM 10/12/1954;
4			X											X	X		X		2						

TOWNSHIP 05 NORTH RANGE 06 WEST OF THE GILA & SALT RIVER MERIDIAN, ARIZONA

SECS	SUBDIVISION																Acres	Kind of Entry or Purpose	Serial Number or Order Number	Action Date	Remarks		
	NE 1/4				NW 1/4				SW 1/4				SE 1/4									Lots	Other Description
	NE	NW	SW	SE	NE	NW	SW	SE	NE	NW	SW	SE	NE	NW	SW	SE							
For orders affecting disposal or use of unidentified lands withdrawn for classification, minerals, water, and/or other public purposes, and Indian treaties, refer to Index to Miscellaneous Documents																							
33					X	X	X	X	X	X	X	X							2560.00	LEASE / OG	A-12762	7/8/1980	EFF 8/1/1980; TERM 8/1/1986; OG SIM DEC 1986;
5			X	X			X	X	X	X	X	X	X	X	X	X	1-4						
7	X	X	X	X	X				X	X			X	X	X	X	1-4						
9																		ALL;					
15																		ALL;					
17																		ALL;					
22																		ALL;					
23																		ALL;					
24																		ALL;					
27																		ALL;					
35																		ALL;	7037.76	LEASE / OG	A-14098	3/25/1981	EFF 4/1/1981; TERM 4/1/1984; OG SIM FEB 1985;
26																		ALL;					
34																		ALL; 5N 5W;	1280.00	LEASE / OG	A-14086	3/30/1981	EFF 4/1/1981; TERM 4/1/1986; OG SIM OCT 1986;
3			X	X			X	X	X	X	X	X	X	X	X	X	1-4						
4			X	X			X	X	X	X	X	X	X	X	X	X	1-4						
6			X	X			X	X			X	X	X	X	X	X	1-7						
8																		ALL;					
10																		ALL;					
13																		ALL;	3835.13	LEASE / OG	A-14958	5/27/1981	EFF 6/1/1981; TERM 6/1/1985; OG SIM;
11																		ALL;	640.00	LEASE / OG	A-15543	5/29/1981	EFF 6/1/1981; TERM 6/1/1983; OG SIM SEP 1983;
19								X			X		X				2, 3	1N 4W;		R/W TRANSMISSION LINE	A-10987	10/28/1981	PERPETUAL; RECL;
1							X	X									7						
2																X							
11	X			X									X	X	X								
14		X					X	X	X	X	X												
22																X							
23					X	X			X														
27	X	X	X	X									X										
34					X	X	X	X	X	X	X	X								R/W ROAD	A-23351	6/3/1988	PERPETUAL; RS 2477; LD TP: 2N 5W;
4	X	X	X	X									X	X	X	X							

TOWNSHIP 05 NORTH RANGE 06 WEST OF THE GILA & SALT RIVER MERIDIAN, ARIZONA

SECS	SUBDIVISION																Acres	Kind of Entry or Purpose	Serial Number or Order Number	Action Date	Remarks		
	NE 1/4				NW 1/4				SW 1/4				SE 1/4									Lots	Other Description
	NE	NW	SW	SE	NE	NW	SW	SE	NE	NW	SW	SE	NE	NW	SW	SE							
For orders affecting disposal or use of unidentified lands withdrawn for classification, minerals, water, and/or other public purposes, and Indian treaties, refer to Index to Miscellaneous Documents																							
9	X																						
10					X	X	X	X	X	X	X	X											
13	X	X			X	X																	
14	X	X			X	X																	
15	X	X															N2NENW;	R/W TRANSMISSION LINE	AZA-12037	8/6/1993	PERPETUAL; AMENDED 1/7/1994;		
1									X	X	X	X	X	X	X	X							
12									X	X	X	X	X	X	X	X							
14	X			X														13.80	R/W ROAD	AZA-27761	12/10/1993	TO TERM 12/9/2018; AMENDED 7/19/2001;	
4			X	X									X	X	X	X	2						
9	X																						
10					X	X	X	X	X	X	X	X											
13	X	X			X	X																	
14	X	X			X	X																	
15	X	X															N2NENW;	R/W TRANSMISSION LINE AMENDED	AZA-12037	1/7/1994	PERPETUAL;		
19																	3, 4	R/W ROAD	AZA-24092	10/3/1995	PERPETUAL; OTHER TPS: 5N 7W, 5N 8W, 6N 8W, 6N 9W; AMENDED 4/8/1996;		
19									X			X		X			2, 3	R/W FIBER OPTIC COMMUNICATION SYSTEM	AZA-30316	6/4/1999	TO TERM 10/26/2036; LD TP: 1N 4W;		
1										X													
2				X								X	X		X		2						
11	X																						
12					X													4.02	R/W ROAD	AZA-30979	7/5/2001	TO TERM 7/4/2031;	
1									X	X			X	X									
12	X	X			X	X													R/W ROAD AMENDED	AZA-27761	7/19/2001	TO TERM 12/9/2018;	